



Instruction Manual

Auto Breeze[®] EZ Kleen Head

Export Model No. 3052-01-001



GOLD MEDAL[®] PRODUCTS CO.

10700 Medallion Drive, Cincinnati, Ohio 45241-4807 USA

SAFETY PRECAUTIONS

| | |
|--|---|
| | ⚠ DANGER |
| | <p>Machine must be properly grounded to prevent electrical shock to personnel. Failure to do so could result in serious injury, or death. DO NOT immerse any part of this equipment in water. DO NOT use excessive water when cleaning. Keep cord and plug off the ground and away from moisture. Always unplug the equipment before cleaning or servicing. Make sure all machine switches are in the OFF position before plugging the equipment into the receptacle.</p> <p>008_051514</p> |

| | |
|--|---|
| | ⚠ DANGER |
| | <p>Improper installation, adjustment, alteration, service, or maintenance can cause property damage, injury, or death. Any alterations to this equipment will void the warranty and may cause a dangerous condition. NEVER make alterations to this equipment. Read the Installation, Operating, and Maintenance Instructions thoroughly before installing, servicing, or operating this equipment.</p> <p>014_051514</p> |

| | |
|--|---|
| | ⚠ WARNING |
| | <p>Floss head rotates at high speeds. Operator MUST keep hands and face clear of the floss head to avoid injury. Operator must wear eye protection. Keep all spectators at a reasonable distance, and use a Floss Bubble for added customer protection.</p> <p>015_062714</p> |

| | |
|--|--|
| | ⚠ WARNING |
| | <p>Keep all foreign objects out of floss head. To avoid eye injury, DO NOT fill floss head with sugar while the head is on and rotating.</p> <p>016_010914</p> |

| | |
|--|---|
| | ⚠ WARNING |
| | <p>Burn Hazard. DO NOT touch spinner head. Allow to cool before cleaning or servicing. Avoid contact with molten sugar.</p> <p>006_010914</p> |

| | |
|--|--|
| | ⚠ WARNING |
| | <p>ALWAYS wear safety glasses when servicing this equipment.</p> <p>010_010914</p> |

SAFETY PRECAUTIONS (continued)

| | |
|--|--|
| | ⚠ WARNING |
| | No user serviceable parts inside. Refer servicing to qualified service personnel. 011_051514 |

| | |
|--|---|
| | ⚠ WARNING |
| | Read and understand operator's manual and all other safety instructions before using this equipment. To order copies of the operator's manual go to gmpopcorn.com or write to Gold Medal Products Co., 10700 Medallion Drive, Cincinnati, OH 45241 USA 1-(800)-543-0862 022_010914 |

| | |
|--|---|
| | ⚠ WARNING |
| | DO NOT allow direct contact of this equipment by the public when used in food service locations. Only personnel trained and experienced in the equipment operation may operate this equipment. Carefully read all instructions before operation. 012_010914 |

| | |
|--|--|
| | ⚠ WARNING |
| | This machine is NOT to be operated by minors. 007_010914 |

Note: Improvements are always being made to Gold Medal's equipment. This information may not be the latest available for your purposes. It is critical that you call Gold Medal's Technical Service Department at 1-800-543-0862 for any questions about your machine operations, replacement parts, or any service questions. (Gold Medal Products Co. does not assume any liability for injury due to careless handling and/or reckless operation of this equipment.)

INSTALLATION INSTRUCTIONS

Inspection of Shipment

After unpacking, check thoroughly for any damage which may have occurred in transit. Claims should be filed immediately with the transportation company. The warranty does not cover damage that occurs in transit, or damage caused by abuse, or consequential damage due to the operation of this machine, since it is beyond our control (reference warranty in back of manual).

Manual

Read and understand the operator's manual and all other safety instructions before using this equipment. To order copies of the operator's manual go to gmpopcorn.com or write to Gold Medal Products Co., 10700 Medallion Drive, Cincinnati, OH 45241 USA 1-(800)-543-0862.

Model Description

3052-01-001: Export Auto Breeze cotton candy machine with EZ Kleen Head and an aluminum floss pan.

Items Included with this Unit



Setup

Your new floss machine is completely assembled and tested at the factory.

1. Remove all packing material and tape before starting operation.
2. This unit features the new Lock-N-Go® handles for easy carrying and a quick-lock into transport position. Prior to operation, rotate both Lock-N-Go handles to the vertical position. This allows the bell housing to "float" freely on the springs during operation (see image below).

Note: DO NOT operate the floss machine with the handles in the transport position.

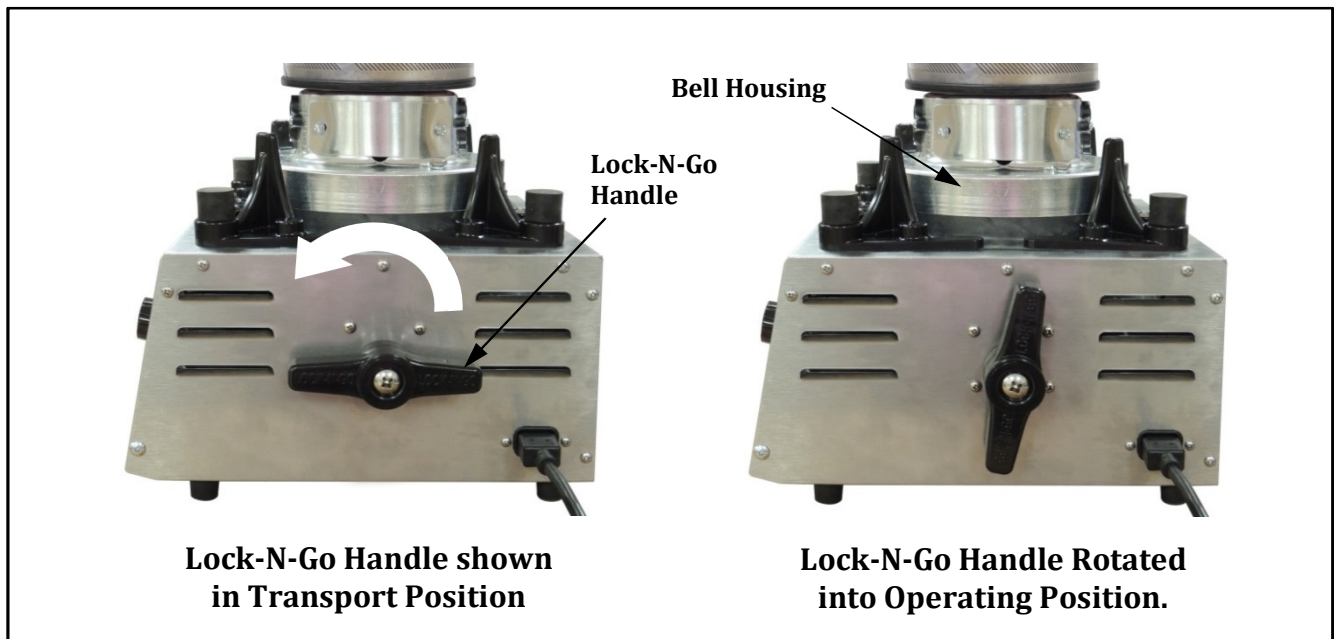

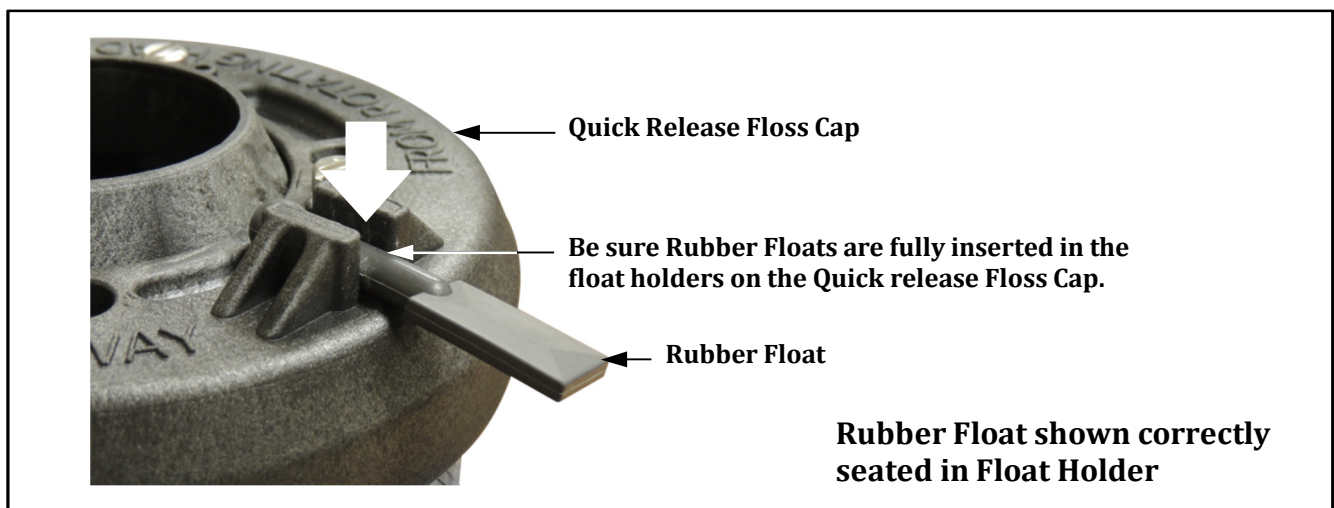

3. Check the Rubber Floats; be sure they are fully inserted in the float holders on the Quick Release Floss Cap (see image below).



Electrical Requirements

The following power supply must be provided:

3052-01-001: 230 V~, 1380 W, 50 Hz

| | |
|---|---|
|  |  DANGER |
| | <p>Machine must be properly grounded to prevent electrical shock to personnel. Failure to do so could result in serious injury, or death. DO NOT immerse any part of this equipment in water. DO NOT use excessive water when cleaning. Keep cord and plug off the ground and away from moisture. Always unplug the equipment before cleaning or servicing. Make sure all machine switches are in the OFF position before plugging the equipment into the receptacle.</p> <p>008_051514</p> |

Your electrician must furnish sufficient power for proper machine operation. We recommend this equipment be on a dedicated and protected circuit. Failure to wire properly will void the warranty and may result in damage to the machine. It is Gold Medal Products Co.'s recommendation that this machine be plugged directly into a wall outlet. The use of extension cords is not recommended due to safety concerns, and may cause sacrificed and/or reduced performance. Make sure cord is located to prevent a trip hazard or unit upset.

Before You Plug In Machine

1. Make sure all machine switches are in the OFF position before plugging the equipment into the receptacle.
2. Make sure the wall outlet can accept the grounded plugs (where applicable) on the power supply cord.
3. The wall outlet must have the proper polarity. If in doubt, have a competent electrician inspect the outlet and correct if necessary.
4. DO NOT use a grounded to un-grounded receptacle adapter (where applicable).
5. Install the unit in a level position.

| | |
|---|--|
|  |  CAUTION |
| | <p>If the supply cord is damaged, it must be replaced by a special cord or assembly available from Gold Medal Products Co. or its service agent.</p> <p>038_062714</p> |

Installation of Floss Stabilizer

Place Floss Machine Pan on unit and install Whirl Grip Floss Stabilizer as shown below.

1. Place a Non-Metallic Whirl Clip over the rim of the Floss Pan. The out facing hooks go to the inside of the Floss Pan.
2. Hang the Non-Metallic screening material onto the up facing hook with the screening approximately flush with the top of the pan. Gently pull the screening down and attach to the down facing hook on the clip to secure screen in place.
3. Check the clip spacing for proper operation.
4. Continue this process with all clips, keeping equal spacing around the pan.

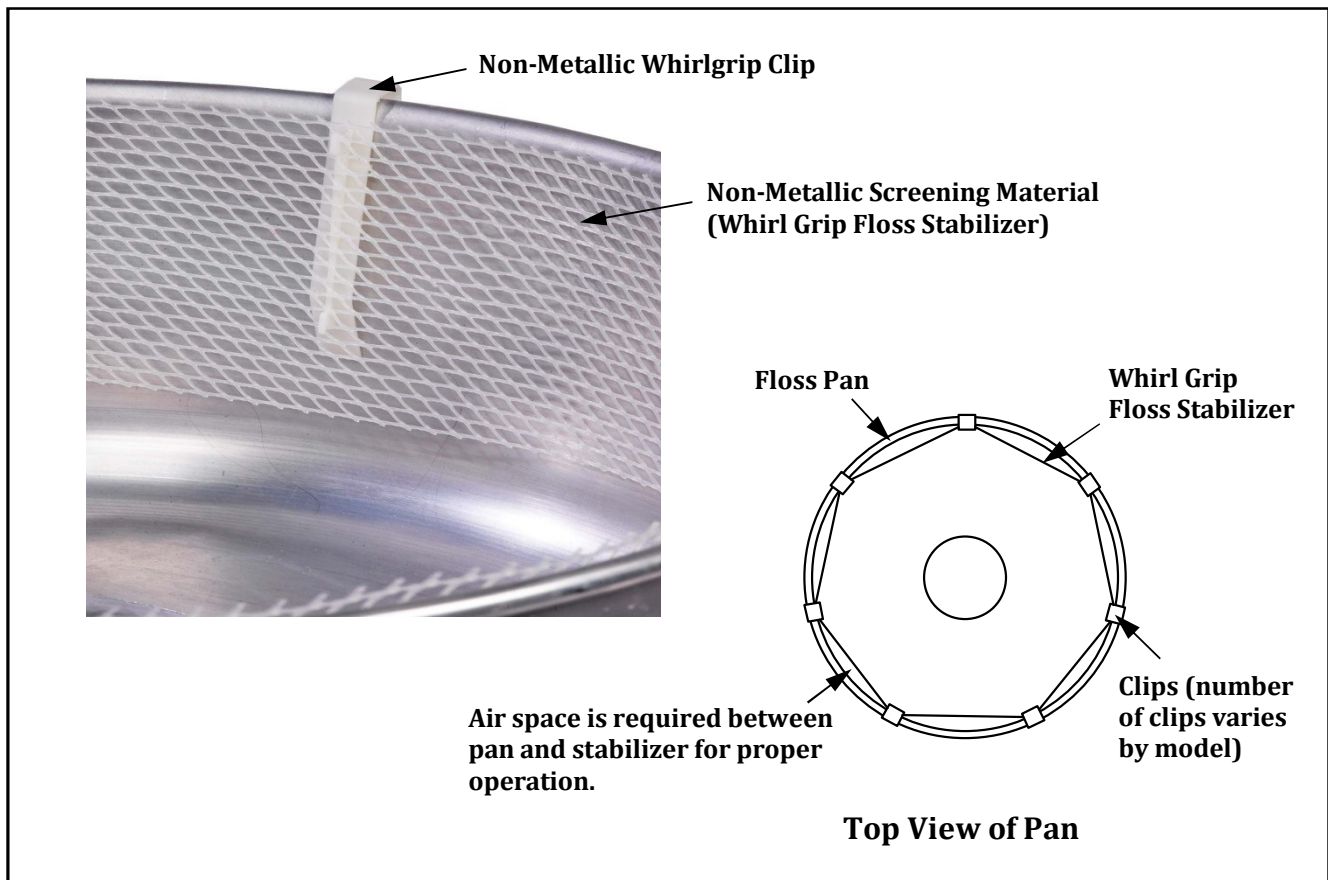

OPERATING INSTRUCTIONS

Controls and Their Functions (3052 Auto Breeze)

POWER SWITCH

Two position, ON/OFF lighted rocker switch - supplies power to the Candy Switch. The green switch light ON indicates there is power to the unit.

Immediate Power Off: To bypass the cooling cycle and immediately remove power from the machine, turn the Power Switch OFF.

CANDY SWITCH

Two position, lighted rocker switch - turns the motor and heating element ON/OFF.

When turned OFF, the cooling cycle will start. After one (1) minute the cooling cycle completes, and the spinner head will stop rotating. Cooling is necessary to keep carbon from forming in the spinner head.

AUTO COOLING INDICATOR LIGHT

When lit, this amber light indicates the unit is in the cooling cycle. During the cooling cycle the spinner head will remain spinning.

If the Auto Cooling Light is blinking during machine operation, it indicates there is a low voltage supply to the machine (less than 210 VAC). The machine may not operate properly (see Troubleshooting section of this manual).





Sugar for Your Candy

Ready to Use Flossugar

Our ready to use Flossugar is the preferred sugar for your new cotton candy machine; however 100% pure cane or beet sugar will do just fine. Our Flossugar gives you good rich colors, and great flavors, too. It is packed in handy half-gallon sealed cartons, with an E-Z pour spout for filling your machine. Flossugar comes in many flavors, and you can easily change flavors for greatest variety, and best sales.

Mix Your Own

If you want to mix your own, use our Flossine[®], and please follow our directions. If you want a deeper color, slightly dampen the mixed sugar. Use a tablespoon of water per five pounds of sugar, sprinkle water over sugar, and mix well. **DO NOT USE EXCESS COLOR!** Too much color will ruin the element on your machine and could create a bitter taste to the candy. There is a limit as to how dark you can make cotton candy. That's because cotton candy is 98% air, and we cannot color the air.

Sugar Considerations

Today 99% of the sugar manufactured is extra fine granulated, which does have some small particles which can slip thru the ribbons without being melted. If this becomes objectionable, you can seek out medium coarse or sanding sugars. The larger crystal size will require a little more heat to melt.

Read the label on the bag of sugar, today we see some free flowing sugars for restaurants. Free flowing sugars contain cornstarch which will burn onto your element/band clogging them rapidly. We have also seen some off-brand sugars that are a blend of sugar and dextrose or corn syrup. This product makes very poor cotton candy. Please make sure you get good sugar for your cotton candy machine.

Machine Operation

Floss Machine Operation (3052 Auto Breeze)

| | |
|---|---|
|  | WARNING |
| | <p>Floss head rotates at high speeds. Operator MUST keep hands and face clear of the floss head to avoid injury. Operator must wear eye protection. Keep all spectators at a reasonable distance, and use a Floss Bubble for added customer protection.</p> <p style="text-align: right;">015_062714</p> |

1. Follow the guidelines described in the Electrical Requirements Section for supplying power to machine.
2. With the Candy Switch OFF, turn the Power Switch ON. The spinner head will not start to rotate.
3. With the spinner head stopped, pour flossugar into the spinner head. Always fill it 90% full with sugar. This 90% level is necessary to obtain a balanced condition in the floss head. **DO NOT OVERFILL!**

IMPORTANT: NEVER add sugar when motor is running.

4. Turn the Candy Switch ON. The spinner head will rotate and heat. After about 30 seconds the machine will start to make cotton candy.
5. When the spinner head needs to be refilled with sugar, or to stop making cotton candy, turn the Candy Switch OFF. The cooling cycle will start. After 1 minute the cooling cycle completes, and the spinner head will stop rotating. When the spinner head is stopped, refill with flossugar. Turn the Candy Switch ON, and continue to make cotton candy.

Note: During the cooling cycle the spinner head will remain spinning. Cooling is necessary to keep carbon from forming in the spinner head. **DO NOT** use the Power Switch for normal operation of the machine. This will bypass the cooling cycle.

IMPORTANT: Failure to cool down the floss head could result in leaving melted sugar in the floss head. If the motor is restarted, this melted sugar will exit the floss head and could cause burns.

In addition, sugar left in the floss head may smoke or cause carbon build up.

Immediate Power Off: To bypass the cooling cycle and immediately remove power from the machine, turn the Power Switch OFF.

When completing operation for the day (or any prolonged period), follow the instructions in the Shutdown Procedure/Cleaning and Care section of this manual.



Making Floss

Pick a cone, if it sticks in the stack of cones, twist it off the stack.

| | |
|--|-------------------------------------|
| | CAUTION |
| | Keep hands away from spinning head! |

031_021914

Hold an inch or two of the pointed end of the cone between two fingers and a thumb. With a light flicking action, roll cone in the web of floss building up in the pan. Lift the cone up with the ring of floss attached and rotate the cone to wrap the floss. **DO NOT** roll floss while the cone is inside the pan. This will pack the floss too tightly. See steps 1 thru 8 shown below.

If the floss fails to stick to the cone, pass the cone near the spinner head to pick up a "starter" of melted sugar. Lift the cone out of the pan and wrap the floss with a "figure eight" movement of the hand. This leaves giant pockets and makes the final product appear larger. Make sure room humidity is not too high, or product will be "heavy".

| | | | |
|-----------------------------------|--|---|--|
| 1. Grip cone as shown. | 2. Break into web of floss with the cone. | 3. Wind the sugar onto the cone. | 4. Lift web of floss from the pan and roll onto the cone. |
| 5. | 6. | 7. | 8. |

| | |
|--|---|
| | WARNING |
| | <ul style="list-style-type: none">• DO NOT PUT HANDS OR OBJECTS IN ROTATING SPINNER HEAD.• DO NOT FILL SPINNER HEAD WITH SUGAR WHILE IT IS ROTATING.• WEAR EYE PROTECTION.• DO NOT PUT HANDS NEAR ROTATING SPINNER HEAD.• USE FLOSS CONE TO COLLECT COTTON CANDY. |

032_021914

Rubber Float Adjustment

In operation, the floss will collect on the FLOSS STABILIZER. If the floss collects “low” on the stabilizer, twist the front (leading) edge of the rubber floats down (as shown below). This creates a lifting action to float the floss higher on the wall of the floss pan.

Be sure the rubber floats are fully inserted in the float holders on the Quick Release Floss Cap (see image below).

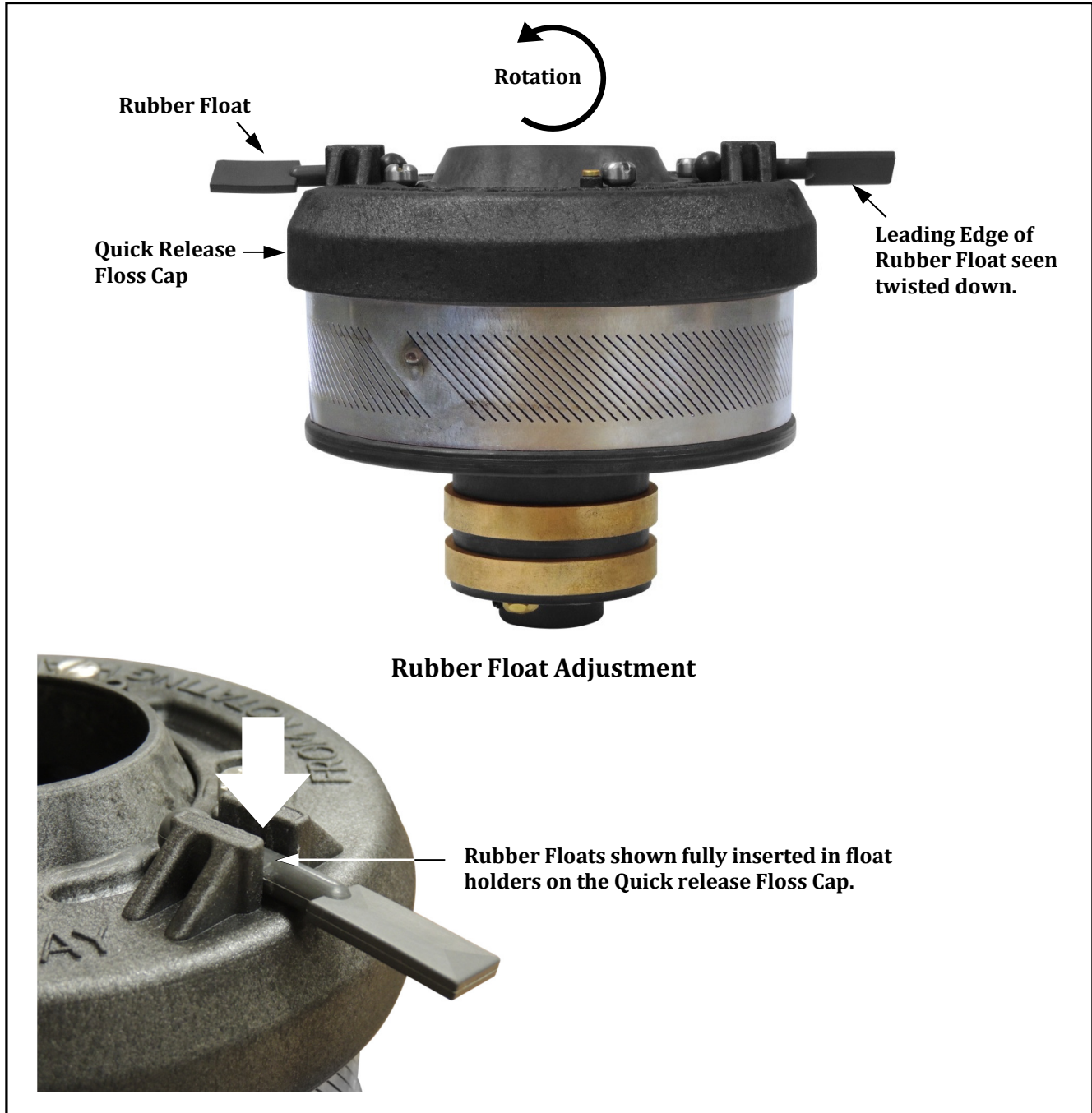



Shut Down Procedure/ Care and Cleaning

Shut Down Procedure (3052 Auto Breeze)

1. When completing operation for the day (or any prolonged period), run the floss head completely empty of sugar.
2. Turn the Candy Switch OFF. The cooling cycle will start. When the cooling cycle completes, the spinner head will stop rotating.
3. When the spinner head is stopped, turn the Power Switch OFF.
4. **NEVER** put water in the floss head.

Care and Cleaning

| | |
|---|---|
|  | ⚠ DANGER |
| | Machine must be properly grounded to prevent electrical shock to personnel. DO NOT immerse in water. Always unplug the equipment before cleaning or servicing. <small>025_020314</small> |

| | |
|---|--|
|  | ⚠ WARNING |
| | Burn Hazard. DO NOT touch spinner head. Allow to cool before cleaning or servicing. Avoid contact with molten sugar. <small>006_010914</small> |

Good sanitation practice demands that all food preparation equipment be cleaned regularly (only use non-toxic, food grade cleaners). A clean looking, well-kept machine is one of the best ways of advertising your product.

Follow the directions below to clean and sanitize the unit each day after use.

1. Unplug the machine and wait for the floss head to cool down to room temperature.
2. Make sure to clean all pans/accessories in order to sanitize them before each use.
3. Wipe all surfaces with a clean, damp cloth.
4. Wipe the stainless steel parts with a clean cloth and cleaner designed for stainless steel, such as Gold Medal Watchdog Stainless Cleaner (Item No. 2088).

DO NOT use oven cleaners or abrasive materials as they will damage parts of the machine.

Floss Band and Element

Disassembly and Removal of Floss Band

1. Unplug the machine from the power source and allow floss head to cool completely.
2. Remove all sugar from the head of the machine before disassembling. If needed, carefully turn the machine on its side and shake the sugar out.
3. Rotate the Quick Release Floss Cap clockwise to unlock, then lift cap off of the floss head retaining bolts (see image below).
4. Remove the Take-Apart Spinner Cap.
5. Unscrew the ball knob counterclockwise and remove. This knob secures the terminal lock.
6. Lift off the terminal lock which fastens the element lead wires.
7. Lift the two (2) element lead wires off the power studs, then the band and element can be removed from the spinner head.
8. If there is excessive sugar buildup, soak the band and element in hot water until the sugar dissolves. When the sugar has been removed, allow the band and element to dry overnight. (See next page for reassembly).

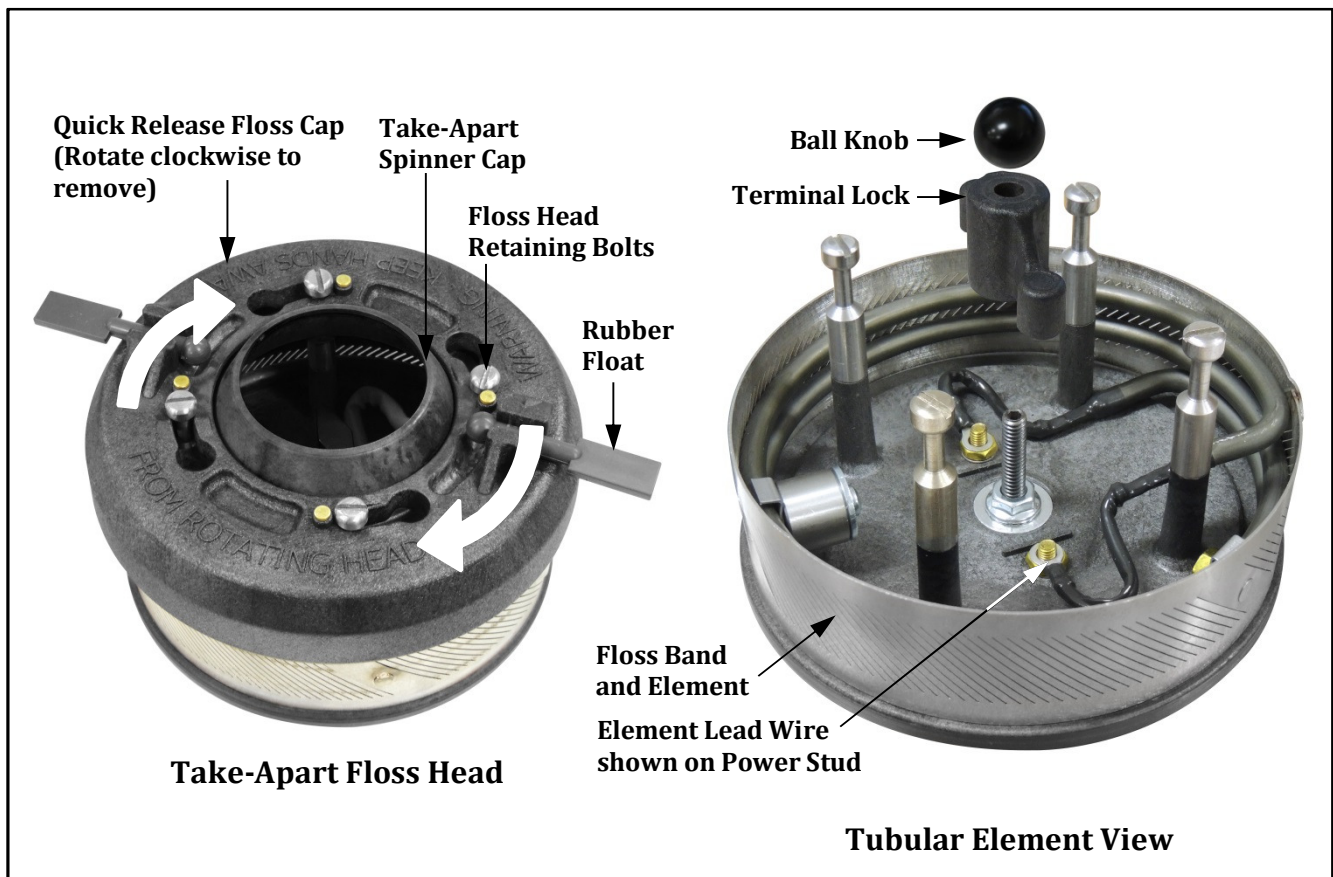

Reassembly of Floss Band and Element

1. When reassembling, the floss band and element must be properly seated on the spinner head groove provided for the Quick Release Floss Cap to correctly and easily lock into place. The band is marked to show correct orientation (see image below).
2. Reattach the (2) element lead wires to the (2) power studs, and secure with the terminal lock and ball knob.
3. Slide the Take-Apart Spinner Cap onto the retaining bolts.
4. Place the Quick Release Floss Cap over the spinner cap and make sure it is fully rotated counterclockwise into the locking position.
5. Check the rubber floats to make sure they are fully inserted in the float holders on the Quick Release Floss Cap.

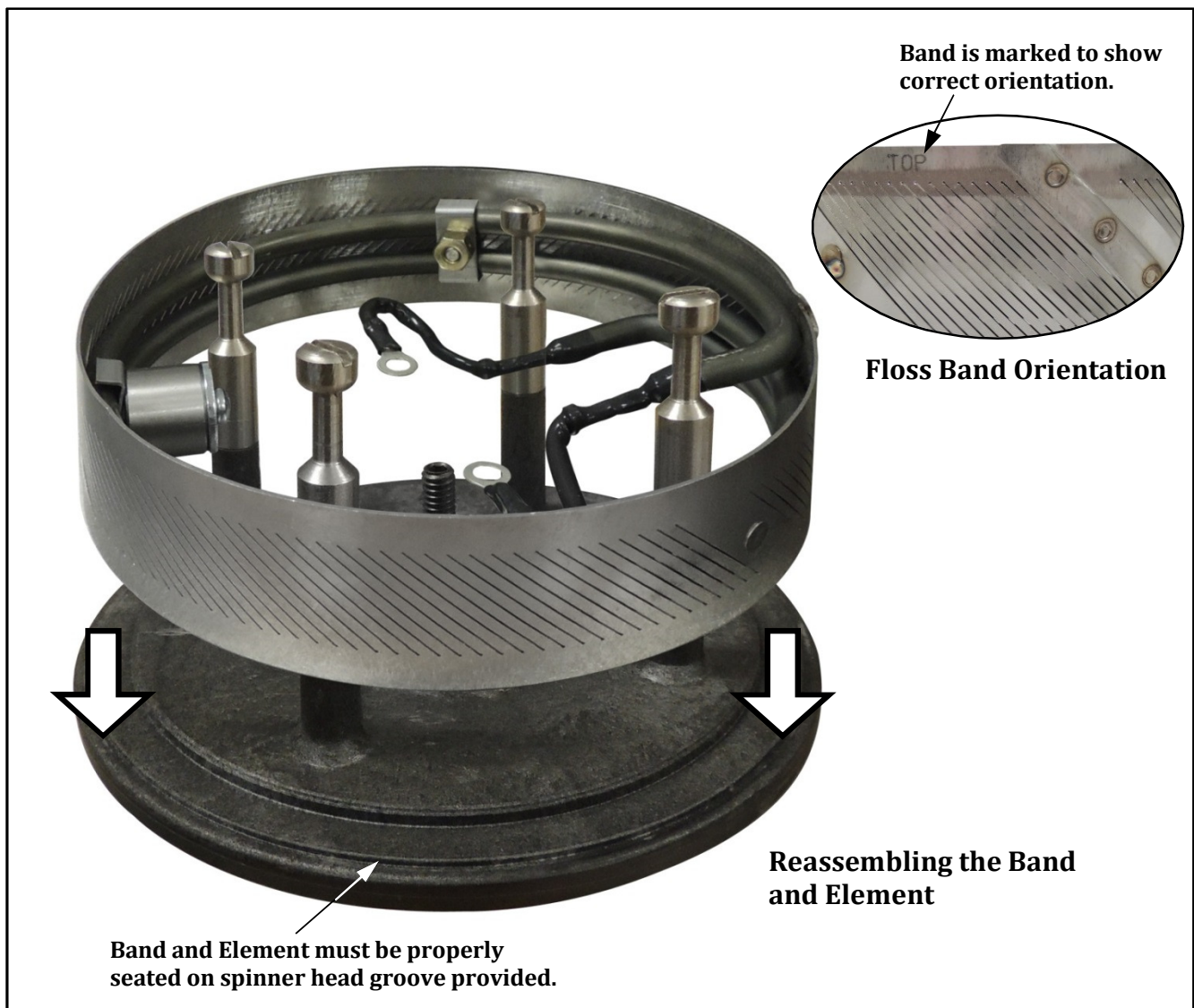



Troubleshooting



| Issue | Possible Cause | Solution |
|---|--|--|
| <p>Low Production</p> | <p>A. Excessive carbon on the element.</p> <p>B. Low line voltage.</p> <p>C. Foreign objects in the spinner head.</p> | <p>A. Follow the instructions for removing and cleaning band and element (see Floss Band and Element section).</p> <p>B. If the Auto Cooling Light is blinking during machine operation, it indicates there is low wall line voltage to the machine (less than 210 VAC). A primary reason for low production and poor equipment performance is low line voltage. Have a qualified electrician check the wall line voltage (where the machine is plugged in), and add new lines for all the various equipment plugged into the electric circuit if there is not enough current for the requirement listed on the equipment nameplate.</p> <p>The use of extension cords is not recommended due to safety concerns, and may cause sacrificed and/or reduced performance. If the use of an extension cord cannot be avoided then be sure it is no longer than 10 to 12 ft., and is at least 1.5mm² wire.</p> <p>C. Foreign objects in the head assembly can short out an element or cause an out-of-balance condition.</p> |
| <p>Excessive Smoke</p> | <p>A. Bypassing the cooling cycle.</p> <p>B. Product mixture.</p> <p>C. Excessive sugar buildup.</p> | <p>A. Bypassing the cooling cycle will cause excessive smoke and melting sugar. This can cause carbon buildup. See Floss Band and Element section of this manual for cleaning the band and element.</p> <p>B. Check the product mixture being used. For best results, use nothing with a cornstarch base.</p> <p>C. Check the band for excessive sugar buildup and remove if needed as described in the Floss Band and Element section of this manual.</p> |
| <p>Excessive Vibration (Continued on next page.)</p> | <p>A. Packing material not removed.</p> <p>B. Lock-N-Go Handles not in operating position.</p> <p>C. Low on sugar.</p> | <p>A. If the equipment is new, check that all packing materials were removed from the machine.</p> <p>B. Verify that the Lock-N-Go Handles have been rotated into the operating position.</p> <p>C. Refill the floss head; this will normally eliminate excessive vibration. When adding sugar to the floss head, always fill it 90% full to obtain a balanced condition in the head and eliminate vibration. Do not add sugar with the motor running!</p> |







| Issue | Possible Cause | Solution |
|---|---|--|
| <p>Excessive Vibration (Continued from previous page.)</p> | <p>D. Foreign objects or sugar lumps.</p> <p>E. Stretched or uneven suspension springs.</p> | <p>D. Run the sugar completely out, then check for foreign objects or sugar lumps in the head assembly.</p> <p>E. If the suspension springs are stretched or uneven this can cause unwanted vibrations. Have Qualified Service Personnel replace if needed.</p> |
| <p>Lock-N-Go Handles are Hard to Rotate</p> | <p>A. Clamping Cam friction.</p> | <p>A. If handles are hard to move, Qualified Service Personnel may need to apply Petro Gel (Gold Medal Item No. 1110), or a food safe lubricant, to the top surface of the Clamping Cam to reduce friction where the cam contacts the bell housing.</p> |
| <p>Quick Release Floss Cap is Hard to Rotate</p> | <p>A. Hard to twist OFF (sugar build up)</p> <p>B. Hard to twist ON (band/element position)</p> | <p>A. If Quick Release Floss Cap is hard to twist off, clean any sugar build up before reinstalling.</p> <p>B. If cap is hard to twist on, check that the band and element are properly seated in spinner head groove provided (see Reassembly of Floss Band and Element).</p> |





MAINTENANCE INSTRUCTIONS

| | |
|---|---|
|  |  DANGER |
| | <p>Machine must be properly grounded to prevent electrical shock to personnel. Failure to do so could result in serious injury, or death. DO NOT immerse any part of this equipment in water. DO NOT use excessive water when cleaning. Keep cord and plug off the ground and away from moisture. Always unplug the equipment before cleaning or servicing. Make sure all machine switches are in the OFF position before plugging the equipment into the receptacle.</p> <p>008_051514</p> |

| | |
|---|---|
|  |  DANGER |
| | <p>Improper installation, adjustment, alteration, service, or maintenance can cause property damage, injury, or death. Any alterations to this equipment will void the warranty and may cause a dangerous condition. NEVER make alterations to this equipment. Read the Installation, Operating, and Maintenance Instructions thoroughly before installing, servicing, or operating this equipment.</p> <p>014_051514</p> |

| | |
|---|--|
|  |  WARNING |
| | <p>No user serviceable parts inside. Refer servicing to qualified service personnel.</p> <p>011_051514</p> |

| | |
|---|---|
|  |  CAUTION |
| | <p>THE FOLLOWING SECTIONS OF THIS MANUAL ARE INTENDED ONLY FOR QUALIFIED SERVICE PERSONNEL WHO ARE FAMILIAR WITH ELECTRICAL EQUIPMENT. THESE ARE NOT INTENDED FOR THE OPERATOR.</p> <p>027_010914</p> |

How to Check a Triac

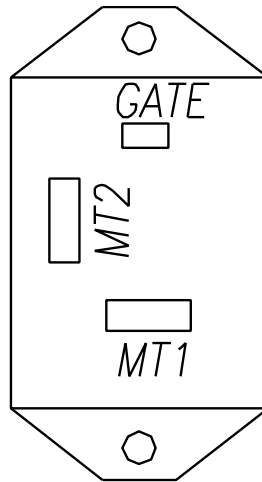

Triac - Top View

1. Set the Multimeter for ohms or continuity.
2. Disconnect all machine leads from the Triac.
3. Connect the positive ohmmeter lead to MT2 and the negative lead to MT1. The ohmmeter should indicate no continuity (OL) through the Triac.
4. Using a separate jumper lead, connect the gate of the Triac to MT2. The ohmmeter should indicate continuity (less than 100 ohms).
5. Reconnect the Triac so MT1 is connected to the positive ohmmeter lead and the negative lead to MT2. The ohmmeter should indicate no continuity (OL) through the Triac.
6. Using a separate jumper lead, connect the gate of the Triac to MT2. The ohmmeter should indicate continuity (less than 100 ohms).



ORDERING SPARE PARTS

1. Identify the needed part by checking it against the photos, illustrations, and/or parts list.
2. Use only approved replacement parts when servicing this unit.
3. When ordering, please include part number, part name, and quantity needed.
4. Please include your model number, serial number, and date of manufacture (located on the machine nameplate/data plate) with your order.
5. Address all parts orders to:

Parts Department
Gold Medal Products Co.
10700 Medallion Drive
Cincinnati, Ohio 45241-4807

Or, place orders by phone or online:

Phone: (800) 543-0862
(513) 769-7676
Fax: (800) 542-1496
(513) 769-8500
E-mail: info@gmpopcorn.com
Web Page: gmpopcorn.com

Cabinet Exterior and Lock-N-Go Handle Assembly

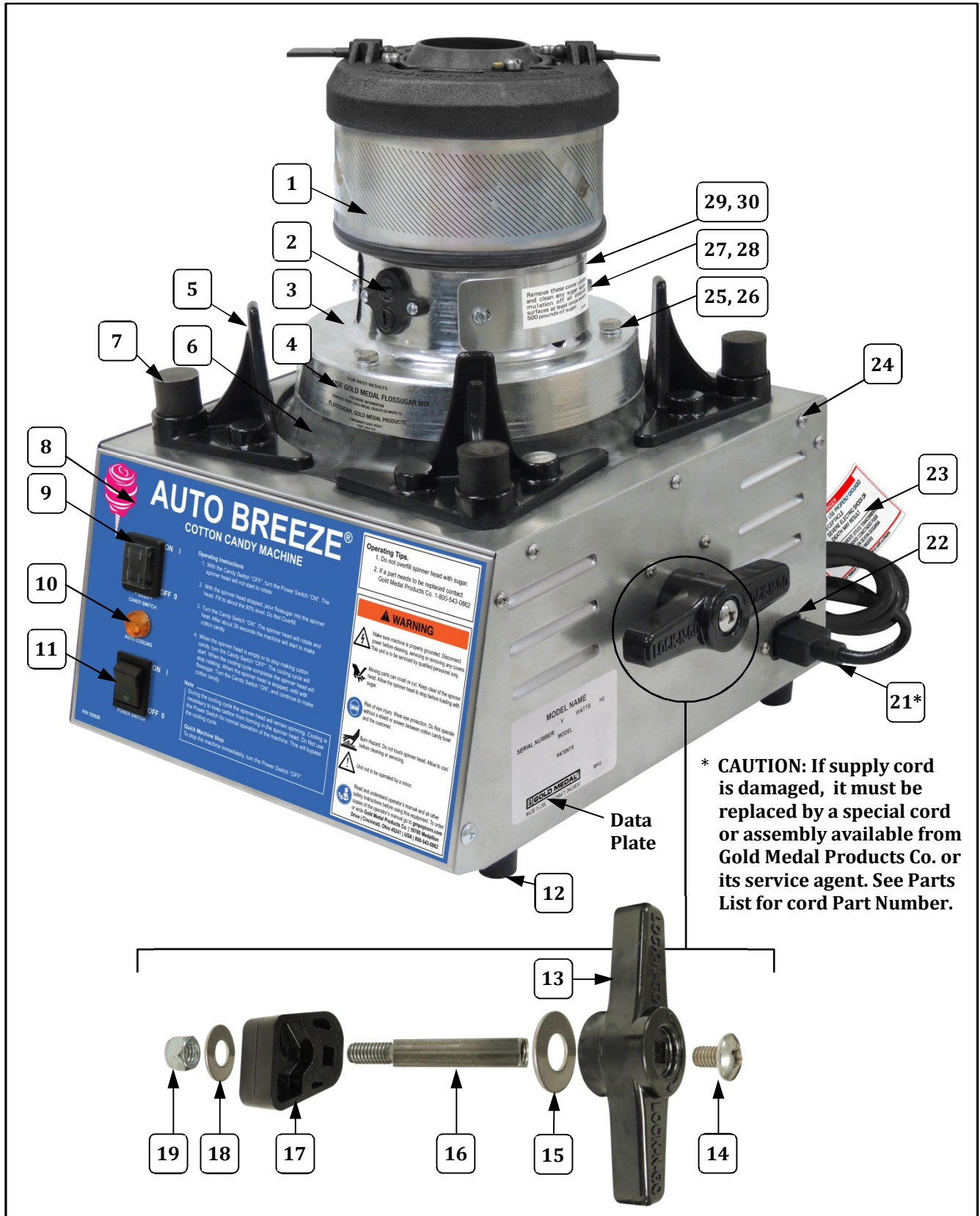



Cabinet Exterior and Lock-N-Go Handle Assembly – Parts List

| Item | Part Description | Part No. |
|------|---|-------------|
| | | 3052-01-001 |
| 1 | SPINNER HEAD, TUBULAR 5IN HEAD (Complete Assembly) See Spinner Head Assembly section for individual parts breakdown. | 55139CX |
| 2 | BRUSH HOLDER ASSY (includes Brushes, Caps and Holders) See Brush Assembly Breakdown section for individual parts breakdown. | 42383W |
| 3 | BELL HOUSING, DUAL BRUSH | 42190 |
| 4 | LABEL,FLOSS ADVERTISEMENT | 42159 |
| 5 | BOWL, SEAL RETAINER | 56561 |
| 6 | BELL HOUSING SEAL | 56571 |
| 7 | THREADED BUMPER,1/4-20 | 102017 |
| 8 | NAME,INSTRUCTION OVERLAY | 102028 |
| 9 | ROCKER SWITCH COVER | 48786 |
| 10 | PILOT LIGHT, AMBER 230V | 55039EX |
| 11 | SWITCH, LIGHTED ROCKER GR | 42798 |
| 12 | RUBBER FOOT 3/4IN HIGH | 47155 |
| 13 | LOCK N GO HANDLE, NEW CAB. | 56563 |
| 14 | 5/16-18 X 1/2 PH TR M/S | 12183 |
| 15 | WASHER SS .5 ID X 1.10 OD | 48428 |
| 16 | CLAMPING SHAFT, LOCK N GO | 56565 |
| 17 | CLAMPING CAM | 42460 |
| 18 | 5/16 FLAT WASHER ZINC PLT | 74134 |
| 19 | HEX NUT 5/16-18 ESLOK | 12001 |
| 20 | N/A | N/A |
| 21* | POWER CORD, IEC SCHUKO | 42372 |
| 22 | IEC CONNECTOR,FLANGED | 102013 |
| 23 | WARNING LABEL CORD | 68720 |
| 24 | 8-32 X 3/8 PHIL PAN HEAD | 87515 |
| 25 | 1/4-20 X 3/4 GRADE 5 BOLT (w/Lock Washer) | 74520 |
| 26 | TINNERMAN NUT 1/4-20 | 42125 |
| 27 | 8-32 X 3/8 SLT. HWH M/S | 42044 |
| 28 | #8-32 TINNERMAN FASTENER | 47299 |
| 29 | INSPECTION BRUSH COVER | 42381 |
| 30 | LABEL,CLEAN EVERY 500 LBS | 42002 |

5" Take Apart Spinner Head (Model No. 55139CX)

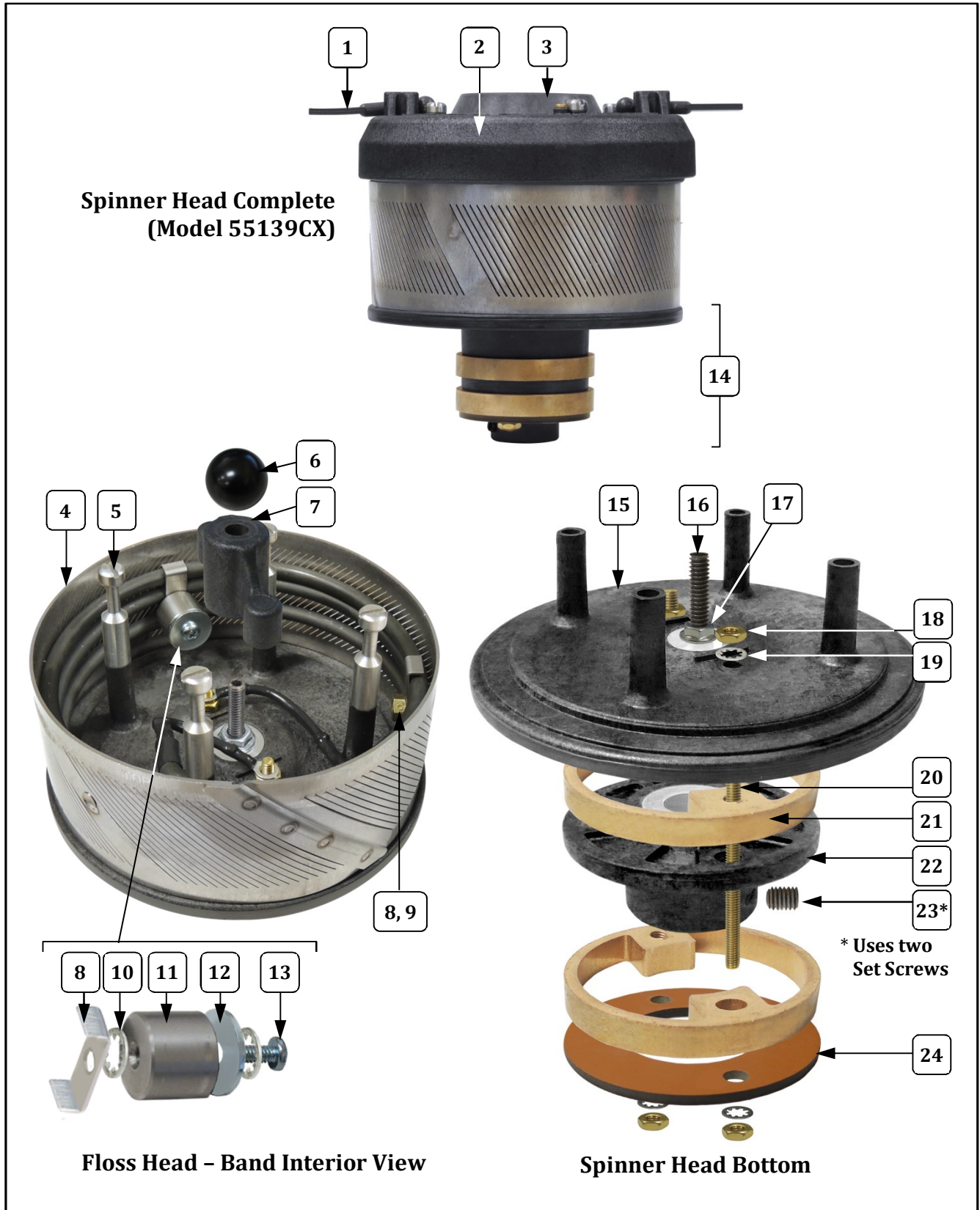



5" Take Apart Spinner Head (Model No. 55139CX) – Parts List

| Item | Part Description | Part No. |
|------|---|----------|
| | | 55139CX |
| 1 | MOLDED RUBBER FLOAT | 56549 |
| 2 | QUICK RELEASE FLOSS CAP (includes 2 Molded Rubber Floats) | 102039 |
| 3 | TAKE-APART SPINNER CAP | 43166C |
| 4 | BREEZE BAND ASSEMBLY (includes element) | 48784EX |
| 5 | FLOSSHEAD RETAINING BOLT | 56550 |
| 6 | BLACK BALL KNOB | 102050 |
| 7 | TERMINAL LOCK | 56551 |
| 8 | FLOSS ELEMENT BRACKET | 55118 |
| 9 | 8-32 LOCKNUT, REVERSIBLE | 48767 |
| 10 | #8 INTERNAL TOOTH L/W 410SS | 12132 |
| 11 | COUNTER WEIGHT | 55006 |
| 12 | .188ID FLATWASHER | 77052 |
| 13 | 8-32 X 5/16 PH PAN M/S | 89247 |
| 14 | SPINNER BOTTOM, TUBULAR (Complete bottom assembly includes Terminal Lock, Ball Knob, and items listed below.) | 42284T |
| 15 | UPPER SPINNER HEAD | 42437 |
| 16 | 1/4-20 x 3IN SET SCREW | 102038 |
| 17 | 1/4-20 SERRATED LOCK NUT | 46311 |
| 18 | HEX NUT #10-32 BRASS | 42301 |
| 19 | #10 INTERNAL TOOTH WASHER | 12573 |
| 20 | SLIP RING STUD | 42127 |
| 21 | SLIP RING 3/8 INCH | 42126 |
| 22 | LOWER SPINNER HEAD 1/2 | 42281 |
| 23 | SET SCREW 1/4-20 X 3/8 (2 required for the Lower Spinner Head) | 74125 |
| 24 | BOTTOM PHENOLIC WASHER | 20054 |

Bell Housing Interior – Brush Assembly

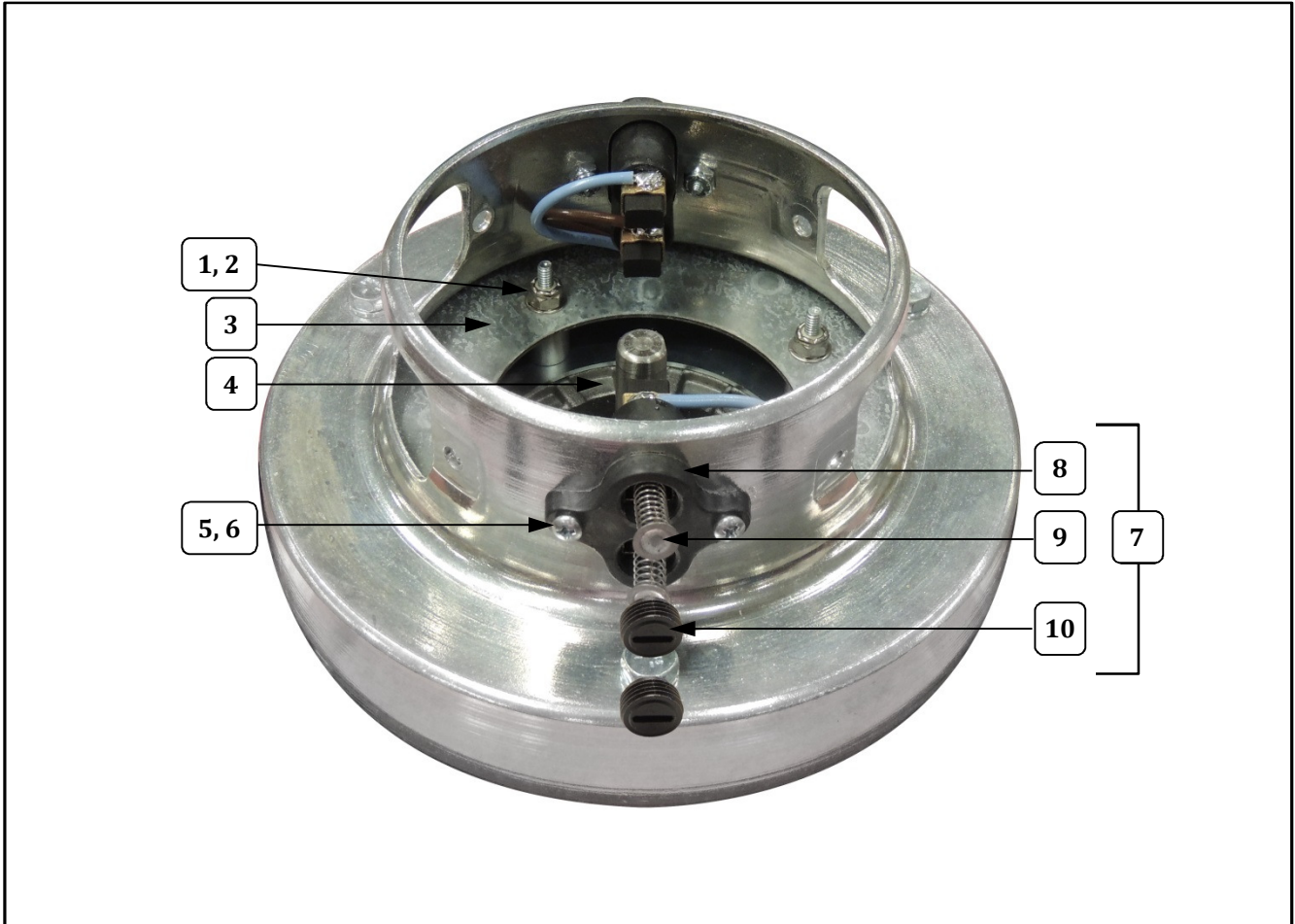

| Item | Part Description | Part No. |
|------|--|-------------|
| | | 3052-01-001 |
| 1 | HEX NUT #10-24 ESLOK | 74691 |
| 2 | .188ID FLATWASHER | 77052 |
| 3 | MOTOR MTG PLATE | 42119 |
| 4 | MOTOR, FLOSS MACHINE | 48649EX |
| 5 | 6-32 X 1/2 PH PAN HD M/S | 47516 |
| 6 | 6-32 GRIP NUT ZINC PLATED | 47517 |
| 7 | BRUSH HOLDER ASSEMBLY (includes Brushes, Caps and Holders) | 42383W |
| 8 | DUAL BRUSH HOLDER W/LEADS | 42384W |
| 9 | CARBON BRUSH | 55007 |
| 10 | CAP, BRUSH HOLDER | 42138 |

Cabinet Interior – Parts Breakdown

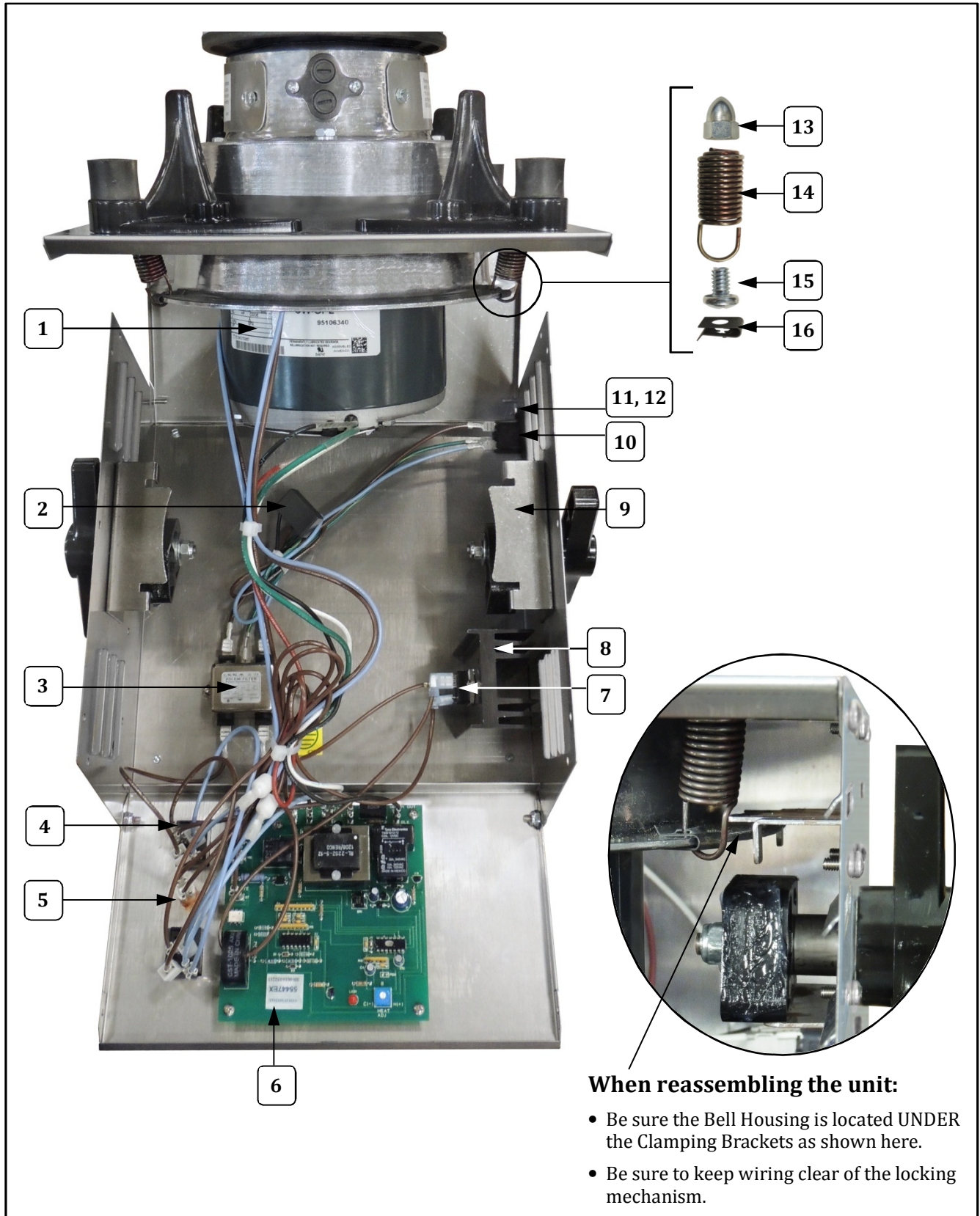

When reassembling the unit:

- Be sure the Bell Housing is located UNDER the Clamping Brackets as shown here.
- Be sure to keep wiring clear of the locking mechanism.

Cabinet Interior - Parts List

| Item | Part Description | Part No. |
|------|---------------------------|-------------|
| | | 3052-01-001 |
| 1 | MOTOR, FLOSS MACHINE | 48649EX |
| 2 | 1UF 250VAC CAPACITOR | 55515 |
| 3 | FILTER, EMI 10 AMP | 13302 |
| 4 | SWITCH, LIGHTED ROCKER GR | 42798 |
| 5 | PILOT LIGHT, AMBER 230V | 55039EX |
| 6 | AUTO WATT CONTROLLER | 55447EX |
| 7 | TRIAC, 35A 600V | 55155 |
| 8 | HEAT SINK | 48673 |
| 9 | CLAMPING BRACKET ASSY | 56578 |
| 10 | IEC CONNECTOR, FLANGED | 102013 |
| 11 | 6-32 X 3/8 PHIL PAN M/S | 39000 |
| 12 | 6-32 GRIP NUT ZINC PLATED | 47517 |
| 13 | ACORN NUT 1/4-20 | 49068 |
| 14 | SPRING, SUSPENSION MEDIUM | 42524 |
| 15 | SCREW 1/4-20X3/8 PN HD PH | 42360 |
| 16 | 10-24 TINNERMAM FASTENER | 42221 |

Floss Pan and Whirlgrip Stabilizer

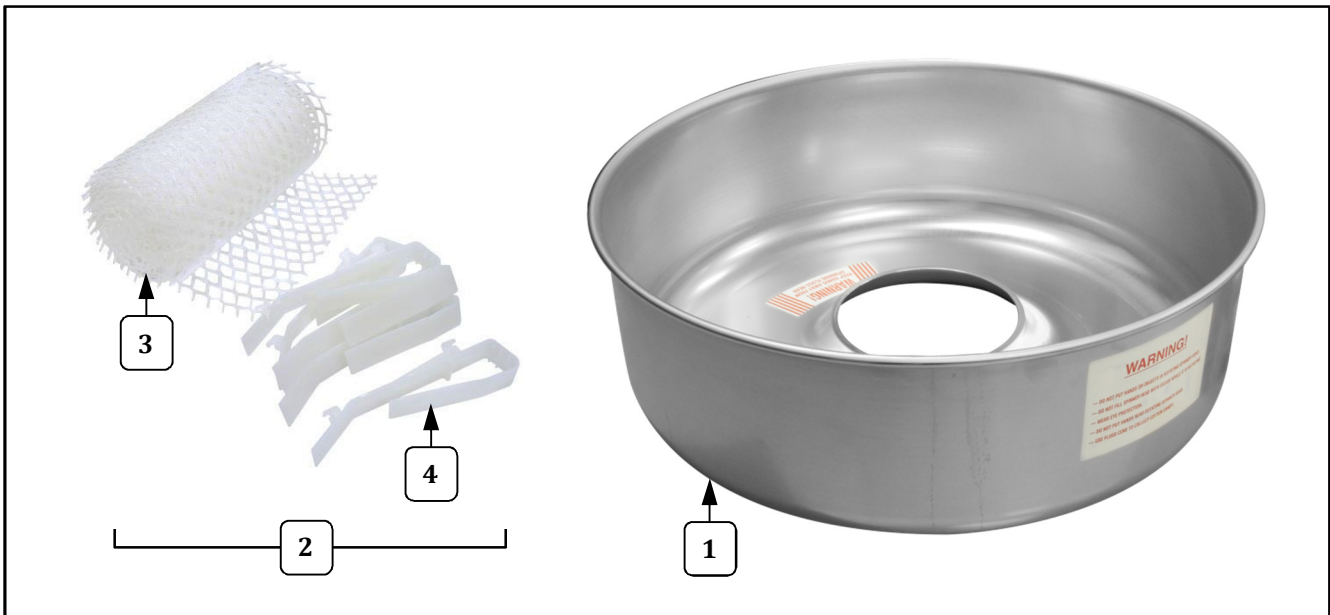

| Item | Part Description | Part No. |
|------|--|-------------|
| | | 3052-01-001 |
| 1 | FLOSS PAN, 0.080 ALUM | 42040 |
| 2 | WHIRLGRIP STABILIZER (Includes Floss Stabilizer and Clips) | 3010 |
| 3 | FLOSS STABILIZER (Web) | 43032 |
| 4 | WHIRLGRIP CLIPS | 77470 |



WARRANTY

Gold Medal Products Co. warrants to the original purchaser each item of its manufacture to be free of defects in workmanship and material under normal use and service. Gold Medal Products Co.'s obligation under this warranty is limited solely to repairing or replacing parts, f.o.b. Cincinnati, Ohio, which in its judgment are defective in workmanship or material and which are returned, freight prepaid, to its Cincinnati, Ohio factory or other designated point. Except for "Perishable Parts" on specific machines, the above warranty applies for a period of two (2) years from the date of original sale to the original purchaser of equipment when recommended operating instructions and maintenance procedures have been followed. These are packed with the machine. Parts warranty is two (2) years, labor is six (6) months.

THIS WARRANTY IS IN LIEU OF ALL OTHER WARRANTIES EXPRESSED OR IMPLIED, AND OF ALL OTHER OBLIGATIONS OR LIABILITIES ON OUR PART, INCLUDING THE IMPLIED WARRANTY OF MERCHANTABILITY. THERE ARE NO WARRANTIES WHICH EXTEND BEYOND THE DESCRIPTION ON THE FACE HEREOF. In no event shall Gold Medal Products Co. be liable for special, incidental or consequential damages. No claim under this warranty will be honored if the equipment covered has been misused, neglected, damaged in transit, or has been tampered with or changed in any way. No claim under this warranty shall be honored in the event that components in the unit at the time of the claim were not supplied or approved by Gold Medal Products Co. This warranty is effective only when electrical items have been properly attached to city utility lines only at proper voltages. This warranty is not transferable without the written consent of Gold Medal Products Co.

The term "Original Purchaser" as used in this warranty shall be deemed to mean that person, firm, association, or corporation who was billed by the GOLD MEDAL PRODUCTS CO., or their authorized distributor for the equipment.

THIS WARRANTY HAS NO EFFECT AND IS VOID UNLESS THE ORIGINAL PURCHASER FIRST CALLS GOLD MEDAL PRODUCTS CO. AT 1-800-543-0862 TO DISCUSS WITH OUR SERVICE REPRESENTATIVE THE EQUIPMENT PROBLEM, AND, IF NECESSARY, FOR INSTRUCTIONS CONCERNING THE REPAIR OR REPLACEMENT OF PARTS.

NOTE: This equipment is manufactured and sold for commercial use only.



GOLD MEDAL[®] PRODUCTS CO.

10700 Medallion Drive, Cincinnati, Ohio 45241-4807 USA

gmpopcorn.com

Phone: (800) 543-0862 Fax: (800) 542-1496
(513) 769-7676 (513) 769-8500